



## **NAV- OG PLADEKÆDEHJUL**

## **SPROCKETS AND PLATE WHEELS**

## **KETTENRÄDER UND KETTENRADSCHIEBEN**

### **Leveringsprogram**

### **Product Range**

### **Lieferprogramm**

### **Side**

### **Page**

### **Seite**

### **Pladekædehjul/Plate Wheels/Kettenradscheiben**

06A (3/8")	111
08A (1/2")	112
10A (5/8")	113
12A (3/4")	114
16A (1")	115
20A (1 1/4")	116
24A (1 1/2")	117

### **Navkædehjul/Sprockets/Kettenräder**

05B (8 mm)	118
06B (3/8")	119
08B (1/2")	120
10B (5/8")	121
12B (3/4")	122
16B (1")	123
20B (1 1/4")	124
24B (1 1/2")	125

<b>Dobbelt for to simplex rullekæder / Double for two simplex roller chains/ Doppel für zwei simplex Rollenketten</b>	<b>126</b>
---	------------

**Mål og materialegenskaber er med forbehold.  
All dimensions and materials may be subject to change.  
Mass- und Materialabweichungen vorbehalten.**

**Leveringsprogram:**

Kædehjul med forboring passer til rullekæder i ISO/R 606, DIN 8187/8188, BS 22B, B29-1 og ANSI.

Yderligere modeller efter ønske.

**Materialer:**

Kædehjul med forboring er fremstillet af stål C45 og i overensstemmelse med DIN 17200, stål 52,3 eller støbejern GG 20-25 som specificeret i dette katalog, eller efter Deres ønske.

**Teknologi:**

Kædehjul med forboring er fremstillet efter den nyeste teknologi. Alle overflader er fuldt afdrejet og afgratet. Boringer, noter, gevind og specielle udførelser efter Deres specifikationer.

**Range:**

Sprockets with pilot bore to suit roller chains conforming to ISO/R 606, DIN 8187/8188, BS 22B, B29-1 and ANSI.

Types not listed on request.

**Materials:**

Sprockets with pilot bore are made from steel C45 conforming to DIN 17200, steel St. 52-3 or Cast iron Grade 220-260 as specified in this catalogue, or according to your specifications.

**Technology:**

Sprockets with pilot bore are all manufactured using the latest technology. All surfaces are fully machined and deburred. Tolerance bores, key-ways, setscrews and special designs according to your specifications.

**Lieferprogramm:**

Kettenräder mit Vorbohrung für Rollenketten nach ISO/R 606, DIN 8187/8188, BS 22B, B29-1 und ANSI.

Nicht aufgeführte Typen auf Anfrage.

**Materialien:**

Kettenräder mit Vorbohrung werden in C45 Stahl nach DIN 17200 bzw. aus St. 52-3 oder Guss GG 20-25 gefertigt wie in diesem Katalog angegeben oder nach Ihrem Wunsch.

**Technologie:**

Kettenräder mit Vorbohrung werden nach neuester Technologie gefertigt. Alle Oberflächen sind gedreht und entgratet. Bohrungen, Keilnuten, Gewindebohrungen und Sonderanfertigungen nach Ihren Wünschen sind möglich.

## Bestillingskode/Code key/Bestellungskode

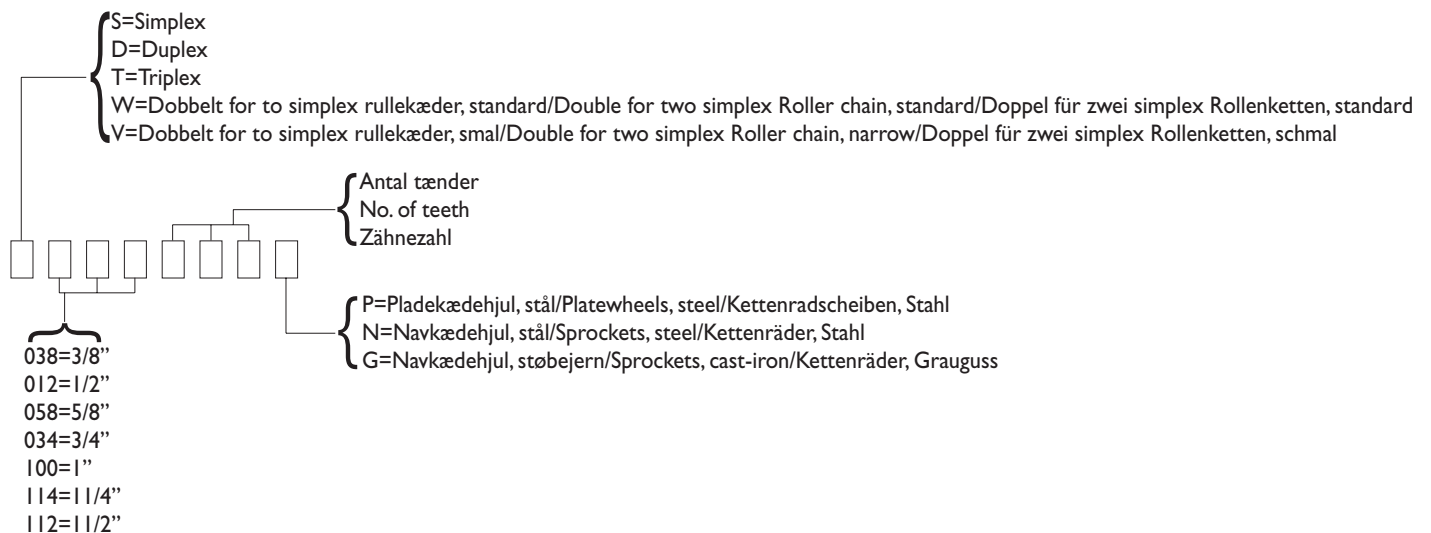

**3/8" X 7/32"**  
**9,525 X 5,72 MM**  
**Ø 6,35 MM**

**06A**  
**3/8"**

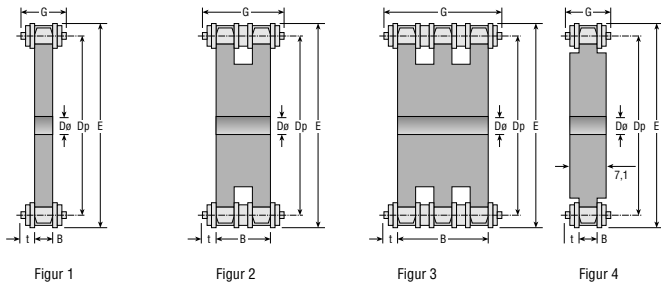

**SIMPLEX B = 5,3**

**DUPLEX B = 15,4**

**TRIPLEX B = 25,6**

Z	Best. nr. Part No Best. Nr.	Fig.	Dø	Best. nr. Part No Best. Nr.	Fig.	Dø	Best. nr. Part No Best. Nr.	Fig.	Dø	Dp	E	t
8	S038008P	1	6	D038008P	2	6	T038008P	3	6	24,89	35	8
9	S038009P	1	8	D038009P	2	8	T038009P	3	8	27,85	37	8
10	S038010P	1	8	D038010P	2	8	T038010P	3	10	30,82	40	8
11	S038011P	1	8	D038011P	2	10	T038011P	3	10	33,80	43	8
12	S038012P	1	8	D038012P	2	10	T038012P	3	10	36,80	46	8
13	S038013P	1	8	D038013P	2	10	T038013P	3	10	39,79	49	8
14	S038014P	1	8	D038014P	2	10	T038014P	3	12	42,80	52	8
15	S038015P	1	8	D038015P	2	10	T038015P	3	12	45,81	55	8
16	S038016P	1	10	D038016P	2	12	T038016P	3	12	48,82	58	8
17	S038017P	1	10	D038017P	2	12	T038017P	3	12	51,83	61	8
18	S038018P	1	10	D038018P	2	12	T038018P	3	12	54,85	64	8
19	S038019P	1	10	D038019P	2	12	T038019P	3	12	57,87	67	8
20	S038020P	1	10	D038020P	2	12	T038020P	3	12	60,89	70	8
21	S038021P	1	10	D038021P	2	12	T038021P	3	14	63,91	73	8
22	S038022P	1	10	D038022P	2	12	T038022P	3	14	66,93	76	8
23	S038023P	1	10	D038023P	2	12	T038023P	3	14	69,95	79	8
24	S038024P	1	10	D038024P	2	12	T038024P	3	14	72,97	82	8
25	S038025P	1	10	D038025P	2	12	T038025P	3	14	76,02	86	8
26	S038026P	1	10	D038026P	2	12	T038026P	3	14	79,02	88	8
27	S038027P	1	10	D038027P	2	12	T038027P	3	14	82,02	91	8
28	S038028P	1	10	D038028P	2	12	T038028P	3	14	85,07	94	8
29	S038029P	1	10	D038029P	2	12	T038029P	3	14	88,09	97	8
30	S038030P	1	10	D038030P	2	12	T038030P	3	14	91,12	100	8
31	S038031P	1	12	D038031P	2	14	T038031P	3	16	94,15	103	8
32	S038032P	1	12	D038032P	2	14	T038032P	3	16	97,17	106	8
33	S038033P	1	12	D038033P	2	14	T038033P	3	16	100,20	109	8
34	S038034P	1	12	D038034P	2	14	T038034P	3	16	103,23	112	8
35	S038035P	1	12	D038035P	2	14	T038035P	3	16	106,26	115	8
36	S038036P	1	12	D038036P	2	14	T038036P	3	16	109,20	118	8
37	S038037P	1	12	D038037P	2	14	T038037P	3	16	112,32	121	8
38	S038038P	1	12	D038038P	2	14	T038038P	3	16	115,35	124	8
39	S038039P	1	12	D038039P	2	14	T038039P	3	16	118,37	127	8
40	S038040P	1	12	D038040P	2	14	T038040P	3	16	121,40	130	8
42	S038042P	4	16	D038042P	2	16	T038042P	3	16	127,46	136	8
45	S038045P	4	16	D038045P	2	16	T038045P	3	16	136,55	145	8
46	S038046P	4	16	D038046P	2	16	T038046P	3	16	139,58	149	8
48	S038048P	4	16	D038048P	2	16	T038048P	3	16	145,64	155	8
50	S038050P	4	16	D038050P	2	16	T038050P	3	16	151,69	161	8
54	S038054P	4	16	D038054P	2	16	T038054P	3	20	163,82	173	8
57	S038057P	4	16	D038057P	2	16	T038057P	3	20	172,91	182	8
60	S038060P	4	16	D038060P	2	16	T038060P	3	20	181,99	191	8
65	S038065P	4	20	D038065P	2	20	T038065P	3	20	197,15	206	8
70	S038070P	4	20	D038070P	2	20	T038070P	3	25	212,30	221	8
76	S038076P	4	20	D038076P	2	20	T038076P	3	25	230,49	240	8
80	S038080P	4	20	D038080P	2	20	T038080P	3	25	242,61	252	8
95	S038095P	4	20	D038095P	2	20	T038095P	3	25	288,08	297	8
114	S038114P	4	20	D038114P	2	20	T038114P	3	25	345,68	355	8

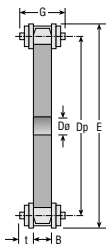

Figur 1

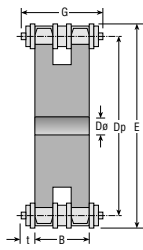

Figur 2

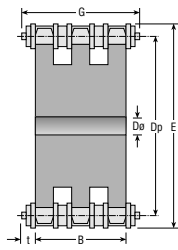

Figur 3

### SIMPLEX B = 7,2

### DUPLEX B = 21

### TRIPLEX B = 34,9

Z	Best. nr. Part No Best. Nr.	Fig.	Dø	Best. nr. Part No Best. Nr.	Fig.	Dø	Best. nr. Part No Best. Nr.	Fig.	Dø	Dp	E	t
8	S012008P	1	8	D012008P	2	10	T012008P	3	10	33,18	45	9
9	S012009P	1	8	D012009P	2	10	T012009P	3	10	37,13	49	9
10	S012010P	1	8	D012010P	2	10	T012010P	3	10	41,10	53	9
11	S012011P	1	10	D012011P	2	10	T012011P	3	12	45,07	57	9
12	S012012P	1	10	D012012P	2	10	T012012P	3	12	49,07	61	9
13	S012013P	1	10	D012013P	2	10	T012013P	3	12	53,06	65	9
14	S012014P	1	10	D012014P	2	10	T012014P	3	12	57,07	69	9
15	S012015P	1	10	D012015P	2	10	T012015P	3	12	61,09	73	9
16	S012016P	1	10	D012016P	2	12	T012016P	3	16	65,10	77	9
17	S012017P	1	10	D012017P	2	12	T012017P	3	16	69,11	81	9
18	S012018P	1	10	D012018P	2	12	T012018P	3	16	73,14	85	9
19	S012019P	1	10	D012019P	2	12	T012019P	3	16	77,16	89	9
20	S012020P	1	10	D012020P	2	12	T012020P	3	16	81,19	94	9
21	S012021P	1	12	D012021P	2	16	T012021P	3	16	85,22	98	9
22	S012022P	1	12	D012022P	2	16	T012022P	3	16	89,24	102	9
23	S012023P	1	12	D012023P	2	16	T012023P	3	16	93,27	106	9
24	S012024P	1	12	D012024P	2	16	T012024P	3	16	97,29	110	9
25	S012025P	1	12	D012025P	2	16	T012025P	3	16	101,33	114	9
26	S012026P	1	16	D012026P	2	16	T012026P	3	16	105,36	118	9
27	S012027P	1	16	D012027P	2	16	T012027P	3	16	109,40	122	9
28	S012028P	1	16	D012028P	2	16	T012028P	3	16	113,42	126	9
29	S012029P	1	16	D012029P	2	16	T012029P	3	16	117,46	130	9
30	S012030P	1	16	D012030P	2	16	T012030P	3	16	121,50	134	9
31	S012031P	1	16	D012031P	2	16	T012031P	3	20	124,54	138	9
32	S012032P	1	16	D012032P	2	16	T012032P	3	20	129,56	142	9
33	S012033P	1	16	D012033P	2	16	T012033P	3	20	133,60	146	9
34	S012034P	1	16	D012034P	2	16	T012034P	3	20	137,64	150	9
35	S012035P	1	16	D012035P	2	16	T012035P	3	20	141,68	154	9
36	S012036P	1	16	D012036P	2	20	T012036P	3	20	145,72	158	9
37	S012037P	1	16	D012037P	2	20	T012037P	3	20	149,76	162	9
38	S012038P	1	16	D012038P	2	20	T012038P	3	20	153,80	166	9
39	S012039P	1	16	D012039P	2	20	T012039P	3	20	157,83	170	9
40	S012040P	1	16	D012040P	2	20	T012040P	3	20	161,87	174	9
42	S012042P	1	20	D012042P	2	20	T012042P	3	25	169,95	182	9
45	S012045P	1	20	D012045P	2	20	T012045P	3	25	182,07	194	9
46	S012046P	1	20	D012046P	2	20	T012046P	3	25	186,10	198	9
48	S012048P	1	20	D012048P	2	20	T012048P	3	25	194,18	206	9
50	S012050P	1	20	D012050P	2	20	T012050P	3	25	202,26	215	9
54	S012054P	1	20	D012054P	2	25	T012054P	3	25	218,43	231	9
57	S012057P	1	20	D012057P	2	25	T012057P	3	25	230,54	243	9
60	S012060P	1	20	D012060P	2	25	T012060P	3	25	242,66	255	9
65	S012065P	1	25	D012065P	2	25	T012065P	3	25	262,86	275	9
70	S012070P	1	25	D012070P	2	25	T012070P	3	25	283,07	296	9
76	S012076P	1	25	D012076P	2	25	T012076P	3	25	307,33	320	9
80	S012080P	1	25	D012080P	2	25	T012080P	3	25	323,48	336	9
95	S012095P	1	25	D012095P	2	25	T012095P	3	25	384,11	396	9
114	S012114P	1	25	D012114P	2	25	T012114P	3	25	460,90	473	9

**5/8" X 3/8"**  
**15,875 X 9,65 MM**  
**Ø 10,16 MM**

**10A**  
**5/8"**

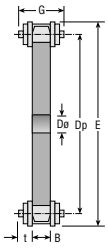

Figur 1

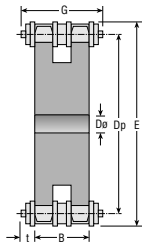

Figur 2

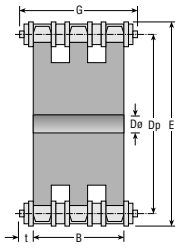

Figur 3

**SIMPLEX B = 9,1**

**DUPLEX B = 25,5**

**TRIPLEX B = 42,1**

Z	Best. nr. Part No Best. Nr.	Fig.	Dø	Best. nr. Part No Best. Nr.	Fig.	Dø	Best. nr. Part No Best. Nr.	Fig.	Dø	Dp	E	t
8	S058008P	1	10	D058008P	2	10	T058008P	3	12	41,48	57	10
9	S058009P	1	10	D058009P	2	10	T058009P	3	12	46,42	62	10
10	S058010P	1	10	D058010P	2	10	T058010P	3	12	51,37	67	10
11	S058011P	1	10	D058011P	2	10	T058011P	3	12	56,34	72	10
12	S058012P	1	10	D058012P	2	10	T058012P	3	12	61,34	77	10
13	S058013P	1	10	D058013P	2	10	T058013P	3	12	66,32	82	10
14	S058014P	1	10	D058014P	2	10	T058014P	3	12	71,34	87	10
15	S058015P	1	10	D058015P	2	10	T058015P	3	12	76,36	92	10
16	S058016P	1	12	D058016P	2	12	T058016P	3	16	81,37	97	10
17	S058017P	1	12	D058017P	2	12	T058017P	3	16	86,39	102	10
18	S058018P	1	12	D058018P	2	12	T058018P	3	16	91,42	107	10
19	S058019P	1	12	D058019P	2	12	T058019P	3	16	96,45	112	10
20	S058020P	1	12	D058020P	2	12	T058020P	3	16	101,49	117	10
21	S058021P	1	12	D058021P	2	16	T058021P	3	16	106,52	122	10
22	S058022P	1	12	D058022P	2	16	T058022P	3	16	111,55	127	10
23	S058023P	1	12	D058023P	2	16	T058023P	3	16	116,58	132	10
24	S058024P	1	12	D058024P	2	16	T058024P	3	16	121,62	137	10
25	S058025P	1	12	D058025P	2	16	T058025P	3	16	126,66	142	10
26	S058026P	1	16	D058026P	2	16	T058026P	3	20	131,70	147	10
27	S058027P	1	16	D058027P	2	16	T058027P	3	20	136,75	152	10
28	S058028P	1	16	D058028P	2	16	T058028P	3	20	141,78	157	10
29	S058029P	1	16	D058029P	2	16	T058029P	3	20	146,83	162	10
30	S058030P	1	16	D058030P	2	16	T058030P	3	20	151,87	167	10
31	S058031P	1	16	D058031P	2	20	T058031P	3	20	156,92	172	10
32	S058032P	1	16	D058032P	2	20	T058032P	3	20	161,95	177	10
33	S058033P	1	16	D058033P	2	20	T058033P	3	20	167,00	182	10
34	S058034P	1	16	D058034P	2	20	T058034P	3	20	172,05	187	10
35	S058035P	1	16	D058035P	2	20	T058035P	3	20	177,10	192	10
36	S058036P	1	20	D058036P	2	20	T058036P	3	25	182,15	197	10
37	S058037P	1	20	D058037P	2	20	T058037P	3	25	187,20	202	10
38	S058038P	1	20	D058038P	2	20	T058038P	3	25	192,24	207	10
39	S058039P	1	20	D058039P	2	20	T058039P	3	25	197,29	213	10
40	S058040P	1	20	D058040P	2	20	T058040P	3	25	202,34	218	10
42	S058042P	1	20	D058042P	2	20	T058042P	3	25	212,44	228	10
45	S058045P	1	20	D058045P	2	20	T058045P	3	25	227,58	243	10
46	S058046P	1	20	D058046P	2	25	T058046P	3	25	232,63	248	10
48	S058048P	1	20	D058048P	2	25	T058048P	3	25	242,73	258	10
50	S058050P	1	20	D058050P	2	25	T058050P	3	25	252,82	268	10
54	S058054P	1	20	D058054P	2	25	T058054P	3	25	273,03	288	10
57	S058057P	1	25	D058057P	2	25	T058057P	3	25	288,18	303	10
60	S058060P	1	25	D058060P	2	25	T058060P	3	25	303,32	319	10
65	S058065P	1	25	D058065P	2	25	T058065P	3	30	328,58	344	10
70	S058070P	1	25	D058070P	2	25	T058070P	3	30	353,84	369	10
76	S058076P	1	25	D058076P	2	25	T058076P	3	30	384,16	399	10
95	S058095P	1	30	D058095P	2	30	T058095P	3	30	480,14	495	10
114	S058114P	1	30	D058114P	2	30	T 012114P	3	30	576,13	591	10

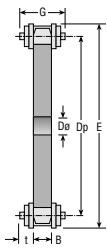

Figur 1

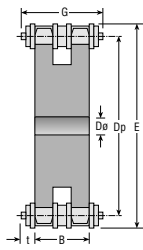

Figur 2

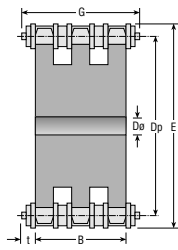

Figur 3

### SIMPLEX B = 11,1

### DUPLEX B = 30,3

### TRIPLEX B = 49,8

Z	Best. nr. Part No Best. Nr.	Fig.	Dø	Best. nr. Part No Best. Nr.	Fig.	Dø	Best. nr. Part No Best. Nr.	Fig.	Dø	Dp	E	t
8	S034008P	1	12	D034008P	2	12	T034008P	3	12	49,78	66	11
9	S034009P	1	12	D034009P	2	12	T034009P	3	12	55,70	72	11
10	S034010P	1	12	D034010P	2	12	T034010P	3	12	61,64	78	11
11	S034011P	1	14	D034011P	2	14	T034011P	3	16	67,61	84	11
12	S034012P	1	14	D034012P	2	14	T034012P	3	16	73,61	90	11
13	S034013P	1	14	D034013P	2	14	T034013P	3	16	79,59	96	11
14	S034014P	1	14	D034014P	2	14	T034014P	3	16	85,61	102	11
15	S034015P	1	14	D034015P	2	14	T034015P	3	16	91,63	108	11
16	S034016P	1	14	D034016P	2	16	T034016P	3	16	97,65	114	11
17	S034017P	1	14	D034017P	2	16	T034017P	3	16	103,67	120	11
18	S034018P	1	14	D034018P	2	16	T034018P	3	16	109,71	126	11
19	S034019P	1	14	D034019P	2	16	T034019P	3	16	115,75	132	11
20	S034020P	1	14	D034020P	2	16	T034020P	3	16	121,78	138	11
21	S034021P	1	16	D034021P	2	16	T034021P	3	20	127,82	144	11
22	S034022P	1	16	D034022P	2	16	T034022P	3	20	133,86	151	11
23	S034023P	1	16	D034023P	2	16	T034023P	3	20	139,90	157	11
24	S034024P	1	16	D034024P	2	16	T034024P	3	20	145,94	163	11
25	S034025P	1	16	D034025P	2	16	T034025P	3	20	152,00	169	11
26	S034026P	1	16	D034026P	2	20	T034026P	3	20	158,04	175	11
27	S034027P	1	16	D034027P	2	20	T034027P	3	20	164,09	181	11
28	S034028P	1	16	D034028P	2	20	T034028P	3	20	170,13	187	11
29	S034029P	1	16	D034029P	2	20	T034029P	3	20	176,19	193	11
30	S034030P	1	16	D034030P	2	20	T034030P	3	20	182,25	199	11
31	S034031P	1	20	D034031P	2	20	T034031P	3	25	188,31	205	11
32	S034032P	1	20	D034032P	2	20	T034032P	3	25	194,35	211	11
33	S034033P	1	20	D034033P	2	20	T034033P	3	25	200,40	217	11
34	S034034P	1	20	D034034P	2	20	T034034P	3	25	206,46	223	11
35	S034035P	1	20	D034035P	2	20	T034035P	3	25	212,52	229	11
36	S034036P	1	20	D034036P	2	25	T034036P	3	25	218,58	235	11
37	S034037P	1	20	D034037P	2	25	T034037P	3	25	224,64	241	11
38	S034038P	1	20	D034038P	2	25	T034038P	3	25	230,69	247	11
39	S034039P	1	20	D034039P	2	25	T034039P	3	25	236,75	253	11
40	S034040P	1	20	D034040P	2	25	T034040P	3	25	242,81	259	11
42	S034042P	1	25	D034042P	2	25	T034042P	3	25	254,93	273	11
45	S034045P	1	25	D034045P	2	25	T034045P	3	25	273,10	290	11
46	S034046P	1	25	D034046P	2	25	T034046P	3	25	279,16	296	11
48	S034048P	1	25	D034048P	2	25	T034048P	3	25	291,27	308	11
50	S034050P	1	25	D034050P	2	25	T034050P	3	25	303,39	320	11
54	S034054P	1	25	D034054P	2	25	T034054P	3	25	327,64	344	11
57	S034057P	1	25	D034057P	2	25	T034057P	3	30	345,81	362	11
60	S034060P	1	25	D034060P	2	25	T034060P	3	30	363,99	380	11
65	S034065P	1	25	D034065P	2	30	T034065P	3	30	394,29	411	11
70	S034070P	1	30	D034070P	2	30	T034070P	3	30	424,60	442	11
76	S034076P	1	30	D034076P	2	30	T034076P	3	30	460,99	478	11
95	S034095P	1	30	D034095P	2	30	T034095P	3	30	576,17	593	11
114	S034114P	1	30	D034114P	2	30	T034114P	3	30	691,36	708	11

1" X 17,02 MM  
25,4 X 17,02 MM  
Ø 15,88 MM

16A  
1"

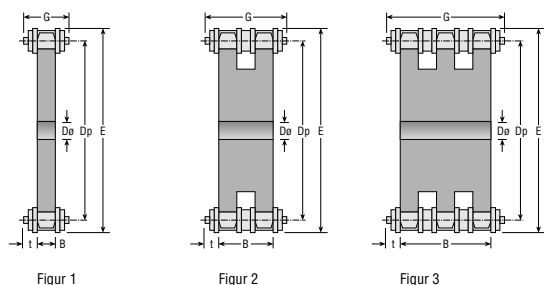

**SIMPLEX B = 16,2**

**DUPLEX B = 47,7**

**TRIPLEX B = 79,6**

Z	Best. nr. Part No Best. Nr.	Fig.	Dø	Best. nr. Part No Best. Nr.	Fig.	Dø	Best. nr. Part No Best. Nr.	Fig.	Dø	Dp	E	t
8	S10008P	1	12	D10008P	2	16	T10008P	3	20	66,37	88	17
9	S10009P	1	12	D10009P	2	16	T10009P	3	20	74,27	96	17
10	S100010P	1	12	D100010P	2	16	T100010P	3	20	82,19	104	17
11	S100011P	1	16	D100011P	2	20	T100011P	3	20	90,14	112	17
12	S100012P	1	16	D100012P	2	20	T100012P	3	20	98,14	120	17
13	S100013P	1	16	D100013P	2	20	T100013P	3	20	106,12	128	17
14	S100014P	1	16	D100014P	2	20	T100014P	3	20	114,15	136	17
15	S100015P	1	16	D100015P	2	20	T100015P	3	20	122,17	144	17
16	S100016P	1	20	D100016P	2	20	T100016P	3	30	130,20	152	17
17	S100017P	1	20	D100017P	2	20	T100017P	3	30	138,22	160	17
18	S100018P	1	20	D100018P	2	20	T100018P	3	30	146,28	168	17
19	S100019P	1	20	D100019P	2	20	T100019P	3	30	154,33	176	17
20	S100020P	1	20	D100020P	2	20	T100020P	3	30	162,38	184	17
21	S100021P	1	20	D100021P	2	25	T100021P	3	30	170,43	192	17
22	S100022P	1	20	D100022P	2	25	T100022P	3	30	178,48	200	17
23	S100023P	1	20	D100023P	2	25	T100023P	3	30	186,53	208	17
24	S100024P	1	20	D100024P	2	25	T100024P	3	30	194,59	216	17
25	S100025P	1	20	D100025P	2	25	T100025P	3	30	202,66	224	17
26	S100026P	1	20	D100026P	2	25	T100026P	3	30	210,72	232	17
27	S100027P	1	20	D100027P	2	25	T100027P	3	30	218,79	240	17
28	S100028P	1	20	D100028P	2	25	T100028P	3	30	226,85	248	17
29	S100029P	1	20	D100029P	2	25	T100029P	3	30	234,92	257	17
30	S100030P	1	20	D100030P	2	25	T100030P	3	30	243,00	265	17
31	S100031P	1	25	D100031P	2	25	T100031P	3	30	251,08	273	17
32	S100032P	1	25	D100032P	2	25	T100032P	3	30	259,13	281	17
33	S100033P	1	25	D100033P	2	25	T100033P	3	30	267,21	289	17
34	S100034P	1	25	D100034P	2	25	T100034P	3	30	275,28	297	17
35	S100035P	1	25	D100035P	2	25	T100035P	3	30	283,36	305	17
36	S100036P	1	25	D100036P	2	25	T100036P	3	30	291,44	313	17
37	S100037P	1	25	D100037P	2	25	T100037P	3	30	299,51	321	17
38	S100038P	1	25	D100038P	2	25	T100038P	3	30	307,59	329	17
39	S100039P	1	25	D100039P	2	25	T100039P	3	30	315,67	337	17
40	S100040P	1	25	D100040P	2	25	T100040P	3	30	323,75	345	17
42	S100042P	1	25	D100042P	2	25	T100042P	3	30	339,90	361	17
45	S100045P	1	25	D100045P	2	25	T100045P	3	30	364,13	386	17
46	S100046P	1	25	D100046P	2	30	T100046P	3	30	372,21	394	17
48	S100048P	1	25	D100048P	2	30	T100048P	3	30	388,36	410	17
50	S100050P	1	25	D100050P	2	30	T100050P	3	30	404,52	426	17
54	S100054P	1	30	D100054P	2	30	T100054P	3	40	436,85	459	17
57	S100057P	1	30	D100057P	2	30	T100057P	3	40	461,07	483	17
60	S100060P	1	30	D100060P	2	30	T100060P	3	40	485,32	507	17
65	S100065P	1	30	D100065P	2	30	T100065P	3	40	525,73	548	17
70	S100070P	1	30	D100070P	2	30	T100070P	3	40	566,14	588	17
76	S100076P	1	30	D100076P	2	30	T100076P	3	40	614,65	636	17
95	S100095P	1	30	D100095P	2	30	T100095P	3	40	768,22	790	17
114	S100114P	1	30	D100114P	2	40	T100114P	3	40	921,81	944	17

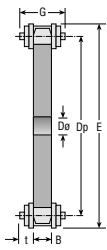

Figur 1

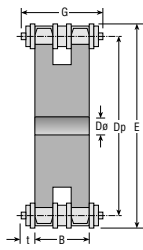

Figur 2

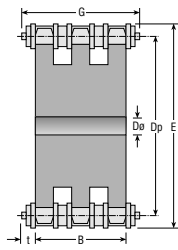

Figur 3

### SIMPLEX B = 18,5

### DUPLEX B = 54,6

### TRIPLEX B = 91

Z	Best. nr. Part No Best. Nr.	Fig.	Dø	Best. nr. Part No Best. Nr.	Fig.	Dø	Best. nr. Part No Best. Nr.	Fig.	Dø	Dp	E	t
8	S114008P	1	16	D114008P	2	20	T114008P	3	20	82,96	110	20
9	S114009P	1	16	D114009P	2	20	T114009P	3	20	92,84	120	20
10	S114010P	1	16	D114010P	2	20	T114010P	3	20	102,74	130	20
11	S114011P	1	16	D114011P	2	20	T114011P	3	20	112,68	140	20
12	S114012P	1	20	D114012P	2	20	T114012P	3	20	122,68	150	20
13	S114013P	1	20	D114013P	2	20	T114013P	3	20	132,65	160	20
14	S114014P	1	20	D114014P	2	20	T114014P	3	20	142,68	170	20
15	S114015P	1	20	D114015P	2	20	T114015P	3	20	152,72	180	20
16	S114016P	1	25	D114016P	2	25	T114016P	3	25	162,75	190	20
17	S114017P	1	25	D114017P	2	25	T114017P	3	25	172,78	200	20
18	S114018P	1	25	D114018P	2	25	T114018P	3	25	182,85	210	20
19	S114019P	1	25	D114019P	2	25	T114019P	3	25	192,91	220	20
20	S114020P	1	25	D114020P	2	25	T114020P	3	25	202,98	230	20
21	S114021P	1	25	D114021P	2	25	T114021P	3	25	213,04	240	20
22	S114022P	1	25	D114022P	2	25	T114022P	3	25	223,11	250	20
23	S114023P	1	25	D114023P	2	25	T114023P	3	25	233,17	260	20
24	S114024P	1	25	D114024P	2	25	T114024P	3	25	243,23	270	20
25	S114025P	1	25	D114025P	2	25	T114025P	3	25	253,33	280	20
26	S114026P	1	25	D114026P	2	25	T114026P	3	25	263,40	290	20
27	S114027P	1	25	D114027P	2	25	T114027P	3	25	273,49	300	20
28	S114028P	1	25	D114028P	2	25	T114028P	3	25	283,56	311	20
29	S114029P	1	25	D114029P	2	25	T114029P	3	25	293,65	321	20
30	S114030P	1	25	D114030P	2	25	T114030P	3	25	303,75	331	20
31	S114031P	1	25	D114031P	2	25	T114031P	3	30	313,85	341	20
32	S114032P	1	25	D114032P	2	25	T114032P	3	30	323,91	351	20
33	S114033P	1	25	D114033P	2	25	T114033P	3	30	334,01	361	20
34	S114034P	1	25	D114034P	2	25	T114034P	3	30	344,10	371	20
35	S114035P	1	25	D114035P	2	25	T114035P	3	30	354,20	381	20
36	S114036P	1	25	D114036P	2	30	T114036P	3	30	364,30	391	20
37	S114037P	1	25	D114037P	2	30	T114037P	3	30	374,39	401	20
38	S114038P	1	25	D114038P	2	30	T114038P	3	30	384,49	411	20
39	S114039P	1	25	D114039P	2	30	T114039P	3	30	394,59	421	20
40	S114040P	1	25	D114040P	2	30	T114040P	3	30	404,69	432	20
42	S114042P	1	30	D114042P	2	30	T114042P	3	40	424,88	452	20
45	S114045P	1	30	D114045P	2	30	T114045P	3	40	455,17	482	20
46	S114046P	1	30	D114046P	2	30	T114046P	3	40	465,26	492	20
48	S114048P	1	30	D114048P	2	30	T114048P	3	40	485,46	513	20
50	S114050P	1	30	D114050P	2	30	T114050P	3	40	505,65	533	20
54	S114054P	1	30	D114054P	2	30	T114054P	3	40	546,07	573	20
57	S114057P	1	30	D114057P	2	30	T114057P	3	40	576,36	603	20
60	S114060P	1	30	D114060P	2	30	T114060P	3	40	606,65	634	20
65	S114065P	1	30	D114065P	2	30	T114065P	3	40	657,16	684	20
70	S114070P	1	30	D114070P	2	30	T114070P	3	40	707,67	735	20
76	S114076P	1	30	D114076P	2	30	T114076P	3	40	768,32	795	20
95	S114095P	1	30	D114095P	2	30	T114095P	3	40	960,28	988	20
114	S114114P	1	30	D114114P	2	40	T114114P	3	40	1152,26	1180	20



1 1/2" X 1"  
38,1 X 25,4 MM  
Ø 25,4 MM

24A  
1 1/2"

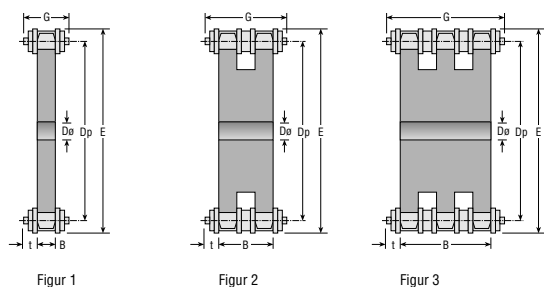

**SIMPLEX B = 24,1**

**DUPLEX B = 72,0**

**TRIPLEX B = 120,3**

Z	Best. nr. Part No Best. Nr.	Fig.	Dø	Best. nr. Part No Best. Nr.	Fig.	Dø	Best. nr. Part No Best. Nr.	Fig.	Dø	Dp	E	t
8	S112008P	1	20	D112008P	2	25	T112008P	3	25	99,55	136	27
9	S112009P	1	20	D112009P	2	25	T112009P	3	25	111,40	148	27
10	S112010P	1	20	D112010P	2	25	T112010P	3	25	123,29	160	27
11	S112011P	1	20	D112011P	2	25	T112011P	3	25	135,21	172	27
12	S112012P	1	20	D112012P	2	25	T112012P	3	25	147,22	184	27
13	S112013P	1	20	D112013P	2	25	T112013P	3	25	159,18	196	27
14	S112014P	1	20	D112014P	2	25	T112014P	3	25	171,22	208	27
15	S112015P	1	20	D112015P	2	25	T112015P	3	25	183,26	220	27
16	S112016P	1	25	D112016P	2	25	T112016P	3	25	195,30	232	27
17	S112017P	1	25	D112017P	2	25	T112017P	3	25	207,34	244	27
18	S112018P	1	25	D112018P	2	25	T112018P	3	25	219,42	256	27
19	S112019P	1	25	D112019P	2	25	T112019P	3	25	231,49	268	27
20	S112020P	1	25	D112020P	2	25	T112020P	3	25	243,57	280	27
21	S112021P	1	25	D112021P	2	25	T112021P	3	30	255,65	292	27
22	S112022P	1	25	D112022P	2	25	T112022P	3	30	267,73	304	27
23	S112023P	1	25	D112023P	2	25	T112023P	3	30	279,80	316	27
24	S112024P	1	25	D112024P	2	25	T112024P	3	30	291,88	328	27
25	S112025P	1	25	D112025P	2	25	T112025P	3	30	304,00	340	27
26	S112026P	1	30	D112026P	2	30	T112026P	3	30	316,08	352	27
27	S112027P	1	30	D112027P	2	30	T112027P	3	30	328,19	364	27
28	S112028P	1	30	D112028P	2	30	T112028P	3	30	340,27	376	27
29	S112029P	1	30	D112029P	2	30	T112029P	3	30	352,38	388	27
30	S112030P	1	30	D112030P	2	30	T112030P	3	30	364,50	400	27
31	S112031P	1	30	D112031P	2	30	T112031P	3	30	376,62	412	27
32	S112032P	1	30	D112032P	2	30	T112032P	3	30	388,69	424	27
33	S112033P	1	30	D112033P	2	30	T112033P	3	30	400,81	436	27
34	S112034P	1	30	D112034P	2	30	T112034P	3	30	412,93	448	27
35	S112035P	1	30	D112035P	2	30	T112035P	3	30	425,04	460	27
36	S112036P	1	30	D112036P	2	30	T112036P	3	30	437,16	472	27
37	S112037P	1	30	D112037P	2	30	T112037P	3	30	449,27	484	27
38	S112038P	1	30	D112038P	2	30	T112038P	3	30	461,39	496	27
39	S112039P	1	30	D112039P	2	30	T112039P	3	30	473,50	508	27
40	S112040P	1	30	D112040P	2	30	T112040P	3	30	485,62	520	27
42	S112042P	1	30	D112042P	2	40	T112042P	3	40	509,85	544	27
45	S112045P	1	30	D112045P	2	40	T112045P	3	40	546,20	580	27
46	S112046P	1	30	D112046P	2	40	T112046P	3	40	558,32	592	27
48	S112048P	1	30	D112048P	2	40	T112048P	3	40	582,55	616	27
50	S112050P	1	30	D112050P	2	40	T112050P	3	40	606,78	640	27
54	S112054P	1	30	D112054P	2	40	T112054P	3	40	655,28	688	27
57	S112057P	1	30	D112057P	2	40	T112057P	3	40	691,63	724	27
60	S112060P	1	30	D112060P	2	40	T112060P	3	40	727,97	760	27
65	S112065P	1	40	D112065P	2	40	T112065P	3	40	788,59	820	27
70	S112070P	1	40	D112070P	2	40	T112070P	3	40	849,21	880	27
76	S112076P	1	40	D112076P	2	40	T112076P	3	40	921,98	956	27
95	S112095P	1	40	D112095P	2	40	T112095P	3	40	1152,33	1184	27

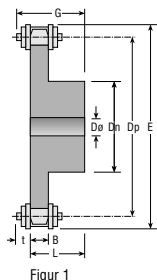

## SIMPLEX B = 2,8

Z	Best. nr. Part No Best. Nr.	Fig.	Dø	Dn	L	Dp
8	S008008N	I	6	13	12	20,90
9	S008009N	I	6	15	12	23,39
10	S008010N	I	8	17	12	25,89
11	S008011N	I	8	18	13	28,39
12	S008012N	I	8	20	13	30,31
13	S008013N	I	8	23	13	33,42
14	S008014N	I	8	25	13	35,95
15	S008015N	I	8	28	13	38,48
16	S008016N	I	8	30	14	41,01
17	S008017N	I	8	30	14	43,53
18	S008018N	I	8	30	14	46,07
19	S008019N	I	8	30	14	48,61
20	S008020N	I	8	30	14	51,14
21	S008021N	I	8	35	14	53,68
22	S008022N	I	8	35	14	56,21
23	S008023N	I	8	35	14	58,75
24	S008024N	I	8	35	14	61,29
25	S008025N	I	8	35	14	63,83
26	S008026N	I	10	40	16	66,37
27	S008027N	I	10	40	16	68,91
28	S008028N	I	10	40	16	71,45
29	S008029N	I	10	40	16	73,99
30	S008030N	I	10	40	16	76,53
31	S008031N	I	10	40	16	79,08
32	S008032N	I	10	40	16	81,61
33	S008033N	I	10	40	16	84,16
34	S008034N	I	10	40	16	86,70
35	S008035N	I	10	40	16	89,25
36	S008036N	I	10	40	16	91,79
37	S008037N	I	10	40	16	94,33
38	S008038N	I	10	40	16	96,88
39	S008039N	I	10	40	16	99,42
40	S008040N	I	10	40	16	101,97
45	S008045N	I	12	60	20	114,69
50	S008050N	I	12	60	20	127,41
57	S008057N	I	14	80	20	145,22
76	S008076N	I	20	80	25	193,59







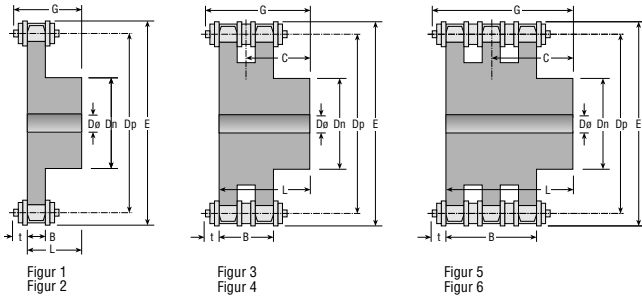

### SIMPLEX B = 11,1

### DUPLEX B = 30,3

### TRIPLEX B = 49,8

Z	Best. nr. Part No	Fig.	Dø	Dn	L	C	Dp	E	t
8	S034008N	1	12	29	30	24,45	49,78	66	11
9	S034009N	1	12	35	30	24,45	55,70	72	11
10	S034010N	1	12	42	30	24,45	61,64	78	11
11	S034011N	1	14	46	35	29,45	67,61	84	11
12	S034012N	1	14	52	35	29,45	73,61	90	11
13	S034013N	1	14	58	35	29,45	79,59	96	11
14	S034014N	1	14	64	35	29,45	85,61	102	11
15	S034015N	1	14	70	35	29,45	91,63	108	11
16	S034016N	1	16	75	35	29,45	97,65	114	11
17	S034017N	1	16	80	35	29,45	103,67	120	11
18	S034018N	1	16	80	35	29,45	109,71	126	11
19	S034019N	1	16	80	35	29,45	115,75	132	11
20	S034020N	1	16	80	35	29,45	121,78	138	11
21	S034021N	2	16	93	40	34,45	127,82	144	11
22	S034022N	2	16	93	40	34,45	133,86	151	11
23	S034023N	2	16	93	40	34,45	139,90	157	11
24	S034024N	2	16	93	40	34,45	145,94	163	11
25	S034025N	2	16	93	40	34,45	152,00	169	11
26	S034026N	2	16	93	40	34,45	158,04	175	11
27	S034027N	2	16	93	40	34,45	164,09	181	11
28	S034028N	2	16	93	40	34,45	170,13	187	11
29	S034029N	2	16	98	40	34,45	176,19	193	11
30	S034030N	2	16	98	40	34,45	182,25	199	11
31	S034031N	2	20	98	40	34,45	188,31	205	11
32	S034032N	2	20	98	40	34,45	194,35	211	11
33	S034033N	2	20	98	40	34,45	200,40	217	11
34	S034034N	2	20	98	40	34,45	206,46	223	11
35	S034035N	2	20	98	40	34,45	212,52	229	11
36	S034036N	2	20	98	40	34,45	218,58	235	11
37	S034037N	2	20	98	40	34,45	224,64	241	11
38	S034038N	2	20	98	40	34,45	230,69	247	11
39	S034039N	2	20	98	40	34,45	236,75	253	11
40	S034040N	2	20	98	40	34,45	242,81	259	11
42	S034042N	2	25	108	56	50,45	254,93	273	11
45	S034045N	2	25	108	56	50,45	273,10	290	11
46	S034046N	2	25	108	56	50,45	279,16	296	11
48	S034048N	2	25	108	56	50,45	291,27	308	11
50	S034050N	2	25	108	56	50,45	303,39	320	11
54	S034054N	2	25	108	56	50,45	327,64	344	11
57	S034057N	2	25	108	56	50,45	345,81	362	11
60	S034060N	2	25	108	56	50,45	363,99	380	11
65	S034065N	2	25	108	56	50,45	394,29	411	11
70	S034070N	2	30	108	56	50,45	424,60	442	11
76	S034076N	2	30	108	56	50,45	460,99	478	11
95	S034095N	2	30	108	56	50,45	576,17	593	11
114	S034114N	2	30	108	56	50,45	691,36	708	11

### STØBEJERN / CAST IRON / GRAUGUSS

Fig. 7: Med eger/With arms/Mit Speicher

38	S034038G	7	23	100	56	50,45	230,69	247	11
45	S034045G	7	23	100	56	50,45	273,10	290	11
57	S034057G	7	29	100	56	50,45	345,81	362	11
76	S034076G	7	29	100	56	~61	460,99	478	11
95	S034095G	7	29	100	65	~61	576,17	593	11
114	S034114G	7	29	100	65	~61	691,36	708	11







1 1/2" X 1"  
38,1 X 25,4 MM  
Ø 25,4 MM

24B  
1 1/2"

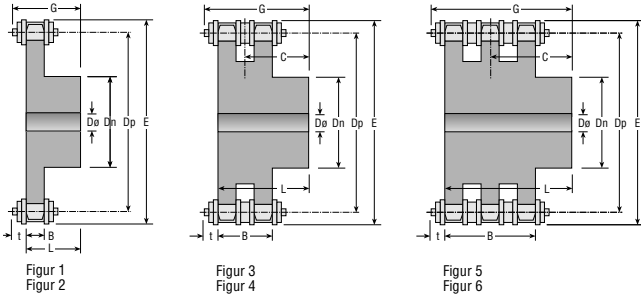

**SIMPLEX B = 24,1**

**DUPLEX B = 72,0**

**TRIPLEX B = 120,3**

Z	Best. nr. Part No Best. Nr.	Fig.	Dø	Dn	L	C	Best. nr. Part No Best. Nr.	Fig.	Dø	Dn	L	C	Best. nr. Part No Best. Nr.	Fig.	Dø	Dn	L	C	Dp	E	t
8	S112008N	1	20	58	45	32,95	D112008N	3	25	58	95	59	T112008N	5	25	58	140	79,85	99,55	136	27
9	S112009N	1	20	70	45	32,95	D112009N	3	25	70	95	59	T112009N	5	25	70	140	79,85	111,40	148	27
10	S112010N	1	20	80	45	32,95	D112010N	3	25	80	95	59	T112010N	5	25	80	140	79,85	123,29	160	27
11	S112011N	1	25	90	50	37,95	D112011N	3	25	90	100	64	T112011N	5	25	90	150	89,85	135,21	172	27
12	S112012N	1	25	102	50	37,95	D112012N	3	25	102	100	64	T112012N	5	25	102	150	89,85	147,22	184	27
13	S112013N	1	25	115	50	37,95	D112013N	3	25	115	100	64	T112013N	5	25	115	150	89,85	159,18	196	27
14	S112014N	2	20	115	50	37,95	D112014N	4	25	115	100	64	T112014N	6	25	115	150	89,85	171,22	208	27
15	S112015N	2	20	115	50	37,95	D112015N	4	25	115	100	64	T112015N	6	25	115	150	89,85	183,26	220	27
16	S112016N	2	25	134	55	42,95	D112016N	4	25	115	100	64	T112016N	6	25	115	150	89,85	195,30	232	27
17	S112017N	2	25	134	55	42,95	D112017N	4	25	115	100	64	T112017N	6	25	115	150	89,85	207,34	244	27
18	S112018N	2	25	134	55	42,95	D112018N	4	25	158	100	64	T112018N	6	25	158	150	89,85	219,42	256	27
19	S112019N	2	25	134	55	42,95	D112019N	4	25	158	100	64	T112019N	6	25	158	150	89,85	231,49	256	27
20	S112020N	2	25	134	55	42,95	D112020N	4	25	158	100	64	T112020N	6	25	158	150	89,85	243,57	280	27
21	S112021N	2	25	158	60	47,95	D112021N	4	25	158	100	64	T112021N	6	30	158	150	89,85	255,65	292	27
22	S112022N	2	25	158	60	47,95	D112022N	4	25	158	100	64	T112022N	6	30	158	150	89,85	267,73	304	27
23	S112023N	2	25	158	60	47,95	D112023N	4	25	158	100	64	T112023N	6	30	158	150	89,85	279,80	316	27
24	S112024N	2	25	158	60	47,95	D112024N	4	25	158	100	64	T112024N	6	30	158	150	89,85	291,88	328	27
25	S112025N	2	25	158	60	47,95	D112025N	4	25	158	100	64	T112025N	6	30	158	150	89,85	304,00	340	27
26	S112026N	2	30	158	60	47,95	D112026N	4	30	158	100	64	T112026N	6	30	158	150	89,85	316,08	352	27
27	S112027N	2	30	158	60	47,95	D112027N	4	30	158	100	64	T112027N	6	30	158	150	89,85	328,19	364	27
28	S112028N	2	30	158	60	47,95	D112028N	4	30	158	100	64	T112028N	6	30	158	150	89,85	340,27	376	27
29	S112029N	2	30	158	60	47,95	D112029N	4	30	158	100	64	T112029N	6	30	158	150	89,85	352,38	388	27
30	S112030N	2	30	158	60	47,95	D112030N	4	30	158	100	64	T112030N	6	30	158	150	89,85	364,50	400	27
31	S112031N	2	30	158	60	47,95	D112031N	4	30	178	100	64	T112031N	6	30	178	150	89,85	376,62	412	27
32	S112032N	2	30	158	60	47,95	D112032N	4	30	178	100	64	T112032N	6	30	178	150	89,85	388,69	424	27
33	S112033N	2	30	158	60	47,95	D112033N	4	30	178	100	64	T112033N	6	30	178	150	89,85	400,81	436	27
34	S112034N	2	30	158	60	47,95	D112034N	4	30	178	100	64	T112034N	6	30	178	150	89,85	412,93	448	27
35	S112035N	2	30	158	60	47,95	D112035N	4	30	178	100	64	T112035N	6	30	178	150	89,85	425,04	460	27
36	S112036N	2	30	158	60	47,95	D112036N	4	30	178	100	64	T112036N	6	30	178	150	89,85	437,16	472	27
37	S112037N	2	30	158	60	47,95	D112037N	4	30	178	100	64	T112037N	6	30	178	150	89,85	449,27	484	27
38	S112038N	2	30	158	60	47,95	D112038N	4	30	178	100	64	T112038N	6	30	178	150	89,85	461,39	496	27
39	S112039N	2	30	158	60	47,95	D112039N	4	30	178	100	64	T112039N	6	30	178	150	89,85	473,50	508	27
40	S112040N	2	30	158	60	47,95	D112040N	4	30	178	100	64	T112040N	6	30	178	150	89,85	485,62	520	27
42	S112042N	2	30	158	90	77,95	D112042N	4	40	178	100	64	T112042N	6	40	198	150	89,85	509,85	544	27
45	S112045N	2	30	158	90	77,95	D112045N	4	40	178	100	64	T112045N	6	40	198	150	89,85	546,20	580	27
46	S112046N	2	30	158	90	77,95	D112046N	4	40	178	100	64	T112046N	6	40	198	150	89,85	558,32	592	27
48	S112048N	2	30	158	90	77,95	D112048N	4	40	178	100	64	T112048N	6	40	198	150	89,85	582,55	616	27
50	S112050N	2	30	158	90	77,95	D112050N	4	40	178	100	64	T112050N	6	40	198	150	89,85	606,78	640	27
54	S112054N	2	30	168	100	87,95	D112054N	4	40	198	110	74	T112054N	6	40	198	150	89,85	655,28	688	27
57	S112057N	2	30	168	100	87,95	D112057N	4	40	198	110	74	T112057N	6	40	198	150	89,85	691,63	724	27
60	S112060N	2	30	168	100	87,95	D112060N	4	40	198	110	74	T112060N	6	40	198	150	89,85	727,97	760	27
65	S112065N	2	40	168	100	87,95	D112065N	4	40	198	110	74	T112065N	6	40	198	150	89,85	788,59	820	27
70	S112070N	2	40	168	100	87,95	D112070N	4	40	198	110	74	T112070N	6	40	198	150	89,85	849,21	880	27
76	S112076N	2	40	168	100	87,95	D112076N	4	40	218	120	84	T112076N	6	40	248	150	89,85	921,98	956	27
95	S112095N	2	40	168	100	87,95	D112095N	4	40	218	120	84	T112095N	6	40	248	150	89,85	1152,33	1184	27

**STØBEJERN / CAST IRON / GRAUGUSS**

Fig. 7: Med eger/With arms/Mit Speicher

30	S112030G	7	39	130	85	77,95	-	-	-	-	-	-	-	-	-	-	-	-	364,50	400	27
38	S112038G	7	44	140	90	77,95	D112038G	7	44	180	100	64	T112038G	7	62	200	150	89,85	461,39	496	27
45	S112045G	7	44	140	90	77,95	-	-	-	-	-	-	-	-	-	-	-	-	546,20	580	27
57	S112057G	7	44	160	100	87,95	D112057G	7	54	200	110	74	T112057G	7	62	200	150	89,85	691,63	724	27
76	S112076G	7	44	170	100	87,95	D112076G	7	54	220	120	84	T112076G	7	69	250	150	89,85	921,98	956	27



**DOBBELT FOR TO SIMPLEX RULLEKÆDER**  
**DOUBLE FOR TWO SIMPLEX ROLLER CHAINS**  
**DOPPEL FÜR ZWEI SIMPLEX ROLLENKETTEN**

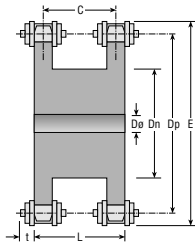

Matr. C45

Kæde/ Chain/Kette	Z	Best. nr. Part No Best. Nr.	TYPEV				Dø	Best. Nr. Part No Best. Nr.	TYPEW					
			Dn	L	C	Dn			L	C	Dø	Dp	E	t
06B 3/8" x 7/32" 9,525 x 5,72 Ø 6,35	15	V038015P	34	22,7	17	12	W038015P	35	23	17,8	10	45,81	55	8
	17	V038017P	41	22,7	17	12	W038017P	41	23	17,8	12	51,83	61	8
	19	V038019P	46	22,7	17	12	W038019P	47	23	17,8	12	57,87	67	8
	21	V038021P	51	22,7	17	12	W038021P	53	23	17,8	15	63,91	73	8
	23	V038023P	58	22,7	17	12	W038023P	60	23	17,8	15	69,95	79	8
	25	V038025P	64	22,7	17	12	W038025P	66	23	17,8	15	76,00	85	8
08B 1/2" x 5/16" 12,7 x 7,75 Ø 8,51	15	V012015P	45	29,0	22	15	W012015P	48	30	23	15	61,09	73	9
	17	V012017P	54	29,0	22	15	W012017P	56	30	23	15	69,11	81	9
	19	V012019P	60	29,0	22	15	W012019P	64	30	23	15	77,16	89	9
	21	V012021P	69	29,0	22	15	W012021P	72	30	23	15	85,22	98	9
	23	V012023P	77	29,0	22	15	W012023P	80	30	23	15	93,27	106	9
	25	V012025P	85	29,0	22	15	W012025P	88	30	23	15	101,33	114	9
10B 5/8" x 3/8" 15,875 x 9,65 Ø 10,16	15	V058015P	57	32,8	24	15	W058015P	60	34	25,2	15	76,36	92	10
	17	V058017P	65	32,8	24	15	W058017P	70	34	25,2	15	86,39	102	10
	19	V058019P	80	32,8	24	20	W058019P	80	34	25,2	20	96,45	112	10
	21	V058021P	85	32,8	24	20	W058021P	90	34	25,2	20	106,52	122	10
	23	V058023P	95	32,8	24	20	W058023P	100	34	25,2	20	116,58	132	10
12B 3/4" x 7/16" 19,05 x 11,68 Ø 12,07	15	V034015P	70	38,6	28	20	W034015P	71	44	33,4	20	91,63	108	11
	17	V034017P	83	38,6	28	20	W034017P	83	44	33,4	20	103,67	120	11
	19	V034019P	90	38,6	28	20	W034019P	95	44	33,4	20	115,75	132	11
	21	V034021P	105	38,6	28	25	W034021P	107	44	33,4	25	127,82	144	11
16B 1" x 17,02 25,4 x 17,02 Ø 15,88	15	V100015P	97	67,4	52	25	W100015P	96	68	52,5	20	122,17	144	17
	17	V100017P	113	67,4	52	30	W100017P	112	68	52,5	25	138,22	160	17
	19	V100019P	124	67,4	52	30	W100019P	128	68	52,5	30	154,33	176	17
	21	V100021P	140	67,4	52	30	W100021P	144	68	52,5	30	170,43	192	17